

110S...M, 110S...AF

DOUBLE-ENDED RING SPANNER SET

- carton box packed
- deep cranked, with thin-walled heads
- matt chrome plated
- break resistance and shatterproof quality minimize risk of injury
- ELORA-Chrome-Vanadium 31CrV3 / 1.2208
- according to DIN 838, ISO 3318, ISO 1085, ISO 10104

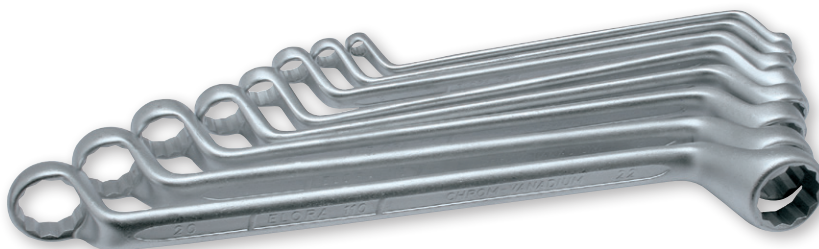

02

mm

AF"

Code	Number	Contents	Pieces	Weight/g
0110500601000	110S 6M	110- 8x9, 10x11, 12x13, 14x15, 16x17, 18x19 mm	1	950
0110500801000	110S 8M	110- 6x7, 8x9, 10x11, 12x13, 14x15, 16x17, 18x19, 20x22 mm	1	1288
0110500821000	110S 8DIN	110- 6x7, 8x9, 10x11, 12x13, 14x15, 16x17, 18x19, 21x22 mm	1	1300
0110501001000	110S 10M	110- 6x7, 8x9, 10x11, 12x13, 14x15, 16x17, 18x19, 20x22, 21x23, 24x27 mm	1	2200
0110501021000	110S 101DIN	110- 6x7, 8x9, 10x11, 12x13, 14x15, 16x17, 18x19, 21x22, 24x26, 30x34 mm	1	2650
0110501011000	110S 101M	110- 6x7, 8x9, 10x11, 12x13, 14x15, 16x17, 18x19, 20x22, 24x27, 30x32 mm	1	2520
0110501021001	110S 10DIN-1	110- 6x7, 8x9, 10x11, 12x13, 14x15, 16x17, 18x19, 21x22, 24x26, 27x32 mm	1	2495
0110501201000	110S 12M	110- 6x7, 8x9, 10x11, 12x13, 14x15, 16x17, 18x19, 20x22, 21x23, 24x27, 25x28, 30x32 mm	1	3320
0110501221000	110S 12DIN	110- 6x7, 8x9, 10x11, 12x13, 14x15, 16x17, 18x19, 20x22, 21x23, 24x26, 27x32, 30x34 mm	1	3630
0110501221002	110S 12DIN-1	110- 6x7, 8x9, 10x11, 12x13, 14x15, 16x17, 18x19, 20x22, 21x23, 24x27, 25x28, 30x32 mm	1	3340

Code	Number	Contents	Pieces	Weight/g
0110600611000	110S 61AF	110A- 1/4x5/16, 3/8x7/16, 1/2x9/16, 5/8x11/16, 3/4x25/32, 13/16x7/8 AF	1	1100
0110600621000	110S 62AF	110A- 3/8x7/16, 1/2x9/16, 5/8x11/16, 3/4x25/32, 13/16x7/8, 15/16x1 AF	1	1480
0110600801000	110S 8AF	110A- 1/4x5/16, 3/8x7/16, 1/2x9/16, 5/8x11/16, 3/4x25/32, 13/16x7/8, 15/16x1, 1.1/16x1.1/4 AF	1	2200
0110601201000	110S 12AF	110A- 1/4x5/16, 5/16x3/8, 3/8x7/16, 7/16x1/2, 1/2x9/16, 9/16x5/8, 5/8x11/16, 3/4x25/32, 13/16x7/8, 15/16x1, 1x1.1/8, 1.1/16x1.1/4 AF	1	3100
0110601401000	110S 14AF	110A- 1/4x5/16, 3/8x7/16, 1/2x9/16, 5/8x11/16, 3/4x25/32, 13/16x7/8, 15/16x1, 1.1/16x1.1/4, 1.1/16x1.1/8, 1.3/16x1.5/16, 1.1/4x1.7/16, 1.7/16x1.5/8, 1.11/16x1.7/8, 1.13/16x2 AF	1	8600

110S...MSB, 110S...AFSB

DOUBLE-ENDED RING SPANNER SET

- in plastic rolling pouch
- with suspension eye
- deep cranked, with thin-walled heads
- matt chrome plated
- break resistance and shatterproof quality minimize risk of injury
- ELORA-Chrome-Vanadium 31CrV3 / 1.2208
- according to DIN 838, ISO 3318, ISO 1085, ISO 10104



mm

AF"

Code	Number	Contents	Pieces	Weight/g
0110500601500	110S 6MSB	110- 6x7, 8x9, 10x11, 12x13, 14x15, 16x17 mm	1	800
0110500801500	110S 8MSB	110- 6x7, 8x9, 10x11, 12x13, 14x15, 16x17, 18x19, 20x22 mm	1	1388
0110500821500	110S 8SBDIN	110- 6x7, 8x9, 10x11, 12x13, 14x15, 16x17, 18x19, 21x22 mm	1	1385

Code	Number	Contents	Pieces	Weight/g
0110600601500	110S 6AFSB	110A- 1/4x5/16, 3/8x7/16, 1/2x9/16, 5/8x11/16, 3/4x25/32, 13/16x7/8 AF	1	1200
0110600801500	110S 8AFSB	110A- 1/4x5/16, 3/8x7/16, 7/16x1/2, 1/2x9/16, 5/8x11/16, 3/4x25/32, 13/16x7/8, 15/16x1 AF	1	1878